



Marion County **OREGON**

PUBLIC WORKS

**BOARD OF
COMMISSIONERS**
Sam Brentano
Janet Carlson
Patti Milne

January 4, 2006

DIRECTOR
James V. Sears, P.E.

ADDENDUM NO. 1

ADMINISTRATION

To All Planholders:

**BUILDING
INSPECTION**

RE: Mill Creek Bridge (Br. NO. 1501) Denver Street - Marion Road SE Bridge Replacement, Grading, Paving and Drainage

DOG CONTROL

ADDENDUM NO.1

**EMERGENCY
MANAGEMENT**

To All Planholders:

ENGINEERING

Please note the following revision to the Introduction:

**ENVIRONMENTAL
SERVICES**

Time for Completion of Work

PARKS

Revise this section to read as follows:

PLANNING

OPERATIONS

Start no work under the contract prior to June 4, 2006, close no road prior to July 5, 2006 and complete all work to be done under the contract not later than August 31, 2006. Close Denver Street and Marion Road SE for no more than one continuous period of 30 calendar days between July 5, 2006 and August 28, 2006 and complete all bridge construction and paving during that period.

SURVEY

Recording of the elapse of calendar days will begin on the day the Contractor begins "on-site work" as defined in 00110.20 of the Standard Specifications.

Please note the following revisions to the Special Provisions:

00330.94 Embankment Basis Payment

Revise this subsection to read as follows:

00330.94 Embankment Basis Payment - In the list of pay items, replace "m³ (Cubic Yard)" with "Lump Sum".

Add the following paragraphs to this subsection:

The estimated quantity of embankment for the entire project is **1900** cubic yards in final position, which consists of the quantity paid for under the item Embankment in Place listed in the "Schedule of Items".

The estimated quantity of excavation including the quantity of material removed below the existing ground surface by Clearing and Grubbing for the entire project is **1000** cubic yards in original position. The estimated quantity of material removed by Clearing and Grubbing is **900** cubic yards. Depth of removal of material by Clearing and Grubbing is **6** inches.

The above quantities do NOT include an estimated 260 Cubic Yard of Toe Trench Excavation for bridge riprap, 340 Cubic Yard of Trench Excavation, or any quantities for the temporary pedestrian bridge.

No subsidence, settlement, shrinkage or swell factors have been applied to the above estimated quantities. Estimated quantities are approximate only and it will be the bidder's responsibility to determine the actual quantities.

The estimated quantities shown above shall serve as a basis for adjustment of payment in the event changes in the work are ordered by the Engineer.

Please note the following revisions to the Supplemental Standard Provisions:

Add Section 00541 - Temporary Bridges:

**MARION COUNTY
SUPPLEMENTAL STANDARD SPECIFICATIONS**

Section 00541, which is not in the Standard Specifications, is included for this project by special provision

Section 00541 - Temporary Bridges

Description

00541.00 Scope - This work consists of furnishing and placing and removing all materials required to provide a temporary bridge as shown on the plans and according to these specifications. The bridge site shall be returned to original condition and grade after bridge removal.

Materials

00541.10 General - Components of the temporary bridge shall comply with applicable sections of Part 00500 Bridges, of the Standard Specifications as modified in the Special Specifications. Materials salvaged from the temporary bridge installation may be incorporated in the project as long as they are not damaged or contaminated. Damaged materials that no longer meet specifications shall be removed from the site at contractor expense.

Construction

00541.40 Construction - Design and construct mud sills such that the bridge slabs are securely supported with a minimum elevation of 290 feet. Place and compact excavated material and aggregate base to comply with ADA requirements for slopes and widths of the pedestrian path. Surface the path with a minimum of 3" of ¾"-0 Aggregate Base at least 4 feet wide.

Measurement

00541.80 General - There will be no measurement of quantities for Temporary Bridge Construction. All materials will be provided on the Lump Sum basis. It will be the contractor's responsibility to design the approaches and determine materials required.

Payment

Payment will be made at the contract price for the following item:

- (a) Temporary Bridge Installation and Removal"Lump Sum

Payment will be payment in full for furnishing and removing all required materials and labor required to complete the installation and removal of the temporary bridge.

Addendum No. 1
January 4, 2006

Page 4 of 8

Please note the following revisions to the Plans:

Replace sheets 2, 2B, 3, 3A and 3B with the enclosed sheets. Changes are clouded and include correcting omissions on the pipe profile and increasing the depth of the pipe run on sheet 3A.

Replace the Schedule of Bid Items with enclosed pages 7, 8, and 9:

Changes to the Schedule of Bid Items include the following:

225.025 TEMPORARY WORK ZONE TRAFFIC CONTROL, COMPLETE
Change the bid item to:
225.050 TEMPORARY PROTECTION AND DIRECTION OF TRAFFIC

442.100 CONTROLLED LOW STRENGTH MATERIAL (CLSM)
Delete the item

9999.054 TEMPORARY BRIDGE INSTALLATION AND REMOVAL
Add the bid item

620.100 COLD PLANE PAVEMENT REMOVAL
Change the bid item to:
620.210 COLD PLANE PAVEMENT REMOVAL, 2" DEEP

Addendum No.1 shall become a part of the Plans and Specifications and shall be binding as though it were contained therein. **Please sign the addendum below and include it in your proposal when submitted.**

If you have any questions, please call me at (503)588-5036.

Sincerely,

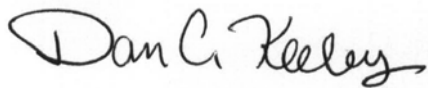

Dan Keeley, P.E.
Civil Engineer

DCK:sen

Addendum No. 1
January 4, 2006

Page 5 of 8

Dated this _____ Day of January, 2006.

ADDENDUM NO.1 CONTENTS READ AND ACKNOWLEDGED

Bidder

By

Enclosed: Schedule of Bid Items

G:\Engineering\ProjectCentral\Projects\Bridge_1501_MillCreek\Design\Specs\Addendums\AddendumNo.1.doc

MILL CREEK BRIDGE (BR. NO. 1501) DENVER ST - MARION RD/DENVER

Schedule Of Bid Items – Addendum #1 January 5, 2006

CONTRACT NUMBER 2006-251

PROJECT NUMBER 1 MILL CREEK BRIDGE (BR. NO. 1501) DENVER ST - MARION RD/DENVER ST

ITEM #	PROJECT ITEM DESCRIPTION	QUANTITY	UNITS	PRICE	AMOUNT
210.100	MOBILIZATION	1	Lump Sum	\$ _____	\$ _____
225.050	TEMPORARY PROTECTION AND DIRECTION OF TRAFFIC	1	Lump Sum	\$ _____	\$ _____
225.070	TEMPORARY SIGNS	420	Square Foot	\$ _____	\$ _____
225.090	AMBER FLASHERS	6	Each	\$ _____	\$ _____
225.114	TEMPORARY BARRICADES, TYPE III	6	Each	\$ _____	\$ _____
225.490	FLAGGERS	700	Hour	\$ _____	\$ _____
280.100	EROSION CONTROL	1	Lump Sum	\$ _____	\$ _____
280.150	CHECK DAMS	2	Each	\$ _____	\$ _____
280.400	SEDIMENT FENCE, SUPPORTED	300	Foot	\$ _____	\$ _____
290.100	POLLUTION CONTROL PLAN	1	Lump Sum	\$ _____	\$ _____
305.100	CONSTRUCTION SURVEY WORK	1	Lump Sum	\$ _____	\$ _____
310.100	REMOVAL OF STRUCTURES AND OBSTRUCTIONS	1	Lump Sum	\$ _____	\$ _____
320.100	CLEARING AND GRUBBING	1	Lump Sum	\$ _____	\$ _____
330.080	TOE TRENCH EXCAVATION	1	Lump Sum	\$ _____	\$ _____
330.460	EMBANKMENT IN PLACE	1	Lump Sum	\$ _____	\$ _____
331.200	12" SUBGRADE STABILIZATION	300	Square Yard	\$ _____	\$ _____
340.100	WATERING	0.1	Million Gallon	\$ _____	\$ _____
350.145	RIPRAP GEOTEXTILE, TYPE 2	500	Square Yard	\$ _____	\$ _____
390.120	LOOSE RIPRAP, CLASS 100	25	Cubic Yard	\$ _____	\$ _____
390.160	LOOSE RIPRAP, CLASS 700	400	Cubic Yard	\$ _____	\$ _____
405.300	3/4"-0 AGGREGATE BEDDING, PIPE ZONE MATERIAL AND BACKFILL	400	Ton	\$ _____	\$ _____
445.199	12" STORM SEWER PIPE	630	Foot	\$ _____	\$ _____
445.450	30" STORM SEWER PIPE	110	Foot	\$ _____	\$ _____
470.200	CONCRETE MANHOLES, WATER QUALITY	2	Each	\$ _____	\$ _____
470.396	CONCRETE INLETS, TYPE G-1, TYPE 2 GRATE	1	Each	\$ _____	\$ _____

MILL CREEK BRIDGE (BR. NO. 1501) DENVER ST - MARION RD/DENVER

Schedule Of Bid Items – Addendum #1 January 5, 2006

470.402	CONCRETE INLETS, TYPE CG-2, TYPE 2 GRATE	1	Each	\$	_____	\$	_____
470.406	CONCRETE INLETS, TYPE CG-3	3	Each	\$	_____	\$	_____
490.100	MINOR ADJUSTMENT OF MANHOLES	3	Each	\$	_____	\$	_____
490.300	MINOR ADJUSTMENT OF BOXES	3	Each	\$	_____	\$	_____
490.350	MAJOR ADJUSTMENT OF BOXES	2	Each	\$	_____	\$	_____
501.100	BRIDGE REMOVAL WORK	1	Lump Sum	\$	_____	\$	_____
510.250	STRUCTURE EXCAVATION	1	Lump Sum	\$	_____	\$	_____
510.800	CONTROLLED LOW STRENGTH MATERIAL BACKFILL	22	Cubic Yard	\$	_____	\$	_____
520.100	FURNISH PILE DRIVING EQUIPMENT	1	Lump Sum	\$	_____	\$	_____
520.220	FURNISH HP 12 X 53 STEEL PILES	600	Foot	\$	_____	\$	_____
520.420	DRIVE HP 12 X 53 STEEL PILES	18	Each	\$	_____	\$	_____
520.620	HP 12 X 53 STEEL PILE SPLICES	3	Each	\$	_____	\$	_____
530.100	REINFORCEMENT	1	Lump Sum	\$	_____	\$	_____
540.155	STRUCTURAL CONCRETE, CLASS 3600	1	Lump Sum	\$	_____	\$	_____
550.325	30" PRECAST PRESTRESSED SLABS	1,053	Foot	\$	_____	\$	_____
587.300	TEXAS TYPE CONCRETE BRIDGE RAIL	1	Lump Sum	\$	_____	\$	_____
596.500	RETAINING WALL, MSE	250	Square Foot	\$	_____	\$	_____
620.210	COLD PLANE PAVEMENT REMOVAL, 2" DEEP	2,500	Square Foot	\$	_____	\$	_____
641.100	1"-0 AGGREGATE BASE	840	Ton	\$	_____	\$	_____
641.200	3/4"-0 AGGREGATE SHOULDERS	220	Ton	\$	_____	\$	_____
745.450	LEVEL 3, 1/2", DENSE, PG 64-22, HMAC	1,900	Ton	\$	_____	\$	_____
745.460	LEVEL 3, 1/2", DENSE, PG 70-22, HMAC	500	Ton	\$	_____	\$	_____
749.100	EXTRA FOR ASPHALT DRIVEWAY APPROACHES	5	Each	\$	_____	\$	_____
749.150	EXTRA FOR ASPHALT ROAD CONNECTIONS	1	Each	\$	_____	\$	_____
749.500	EXTRA FOR ASPHALT SLOPES IN BACK OF SIDEWALKS	600	Square Foot	\$	_____	\$	_____
759.120	CONCRETE CURBS, STANDARD	940	Foot	\$	_____	\$	_____

MILL CREEK BRIDGE (BR. NO. 1501) DENVER ST - MARION RD/DENVER

Schedule Of Bid Items – Addendum #1 January 5, 2006

759.200	CONCRETE DRIVEWAYS	610	Square Foot	\$ _____	\$ _____
759.250	CONCRETE WALKS	5,030	Square Foot	\$ _____	\$ _____
759.400	CONCRETE SIDEWALK RAMPS	2	Each	\$ _____	\$ _____
850.520	THERMOPLASTIC 4" PAVEMENT LINE, TYPE A	190	Foot	\$ _____	\$ _____
860.200	BI-DIRECTIONAL YELLOW TYPE I MARKERS	20	Each	\$ _____	\$ _____
861.100	PAINTED PERMANENT PAVEMENT STRIPING	4,300	Foot	\$ _____	\$ _____
905.150	REMOVE AND REINSTALL EXISTING SIGNS	1	Lump Sum	\$ _____	\$ _____
910.100	WOOD SIGN POSTS	40	Foot Board Measure	\$ _____	\$ _____
940.290	TYPE "W1" SIGNS IN PLACE	23	Square Foot	\$ _____	\$ _____
940.420	TYPE "YG" SIGNS IN PLACE	11	Square Foot	\$ _____	\$ _____
1030.100	PERMANENT SEEDING	0.5	Acre	\$ _____	\$ _____
1040.125	TOPSOIL	5	Cubic Yard	\$ _____	\$ _____
9999.054	TEMPORY BRIDGE INSTALLATION AND REMOVAL	1	Lump sum	\$ _____	\$ _____

CONTRACT NUMBER 2006-251 - TOTAL EXTENSION

\$ _____

TYPICAL SECTIONS

"L" LINE

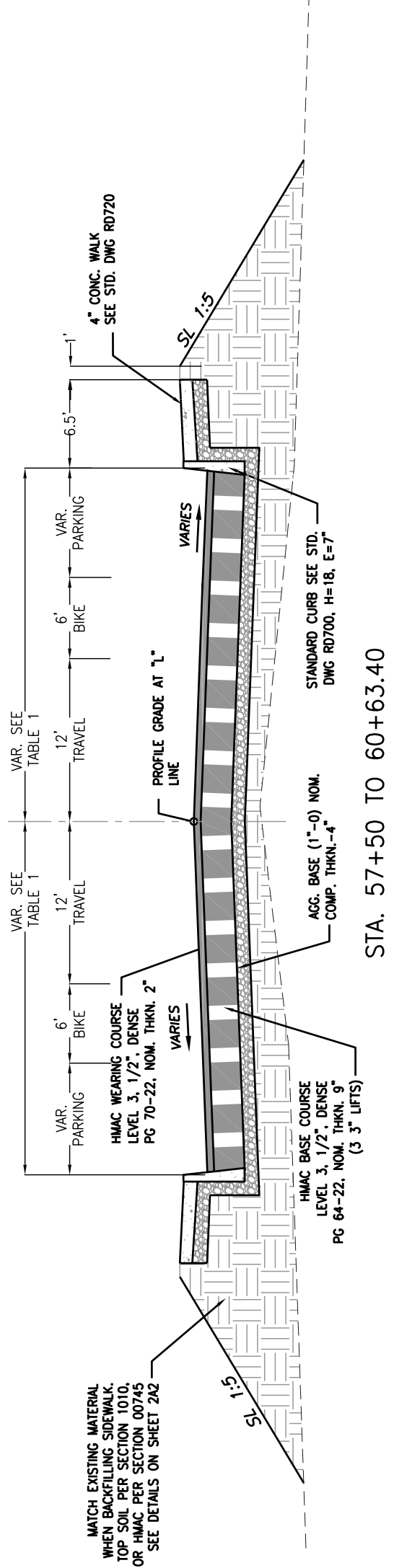

STA. 57+50 TO 60+63.40

"L" LINE

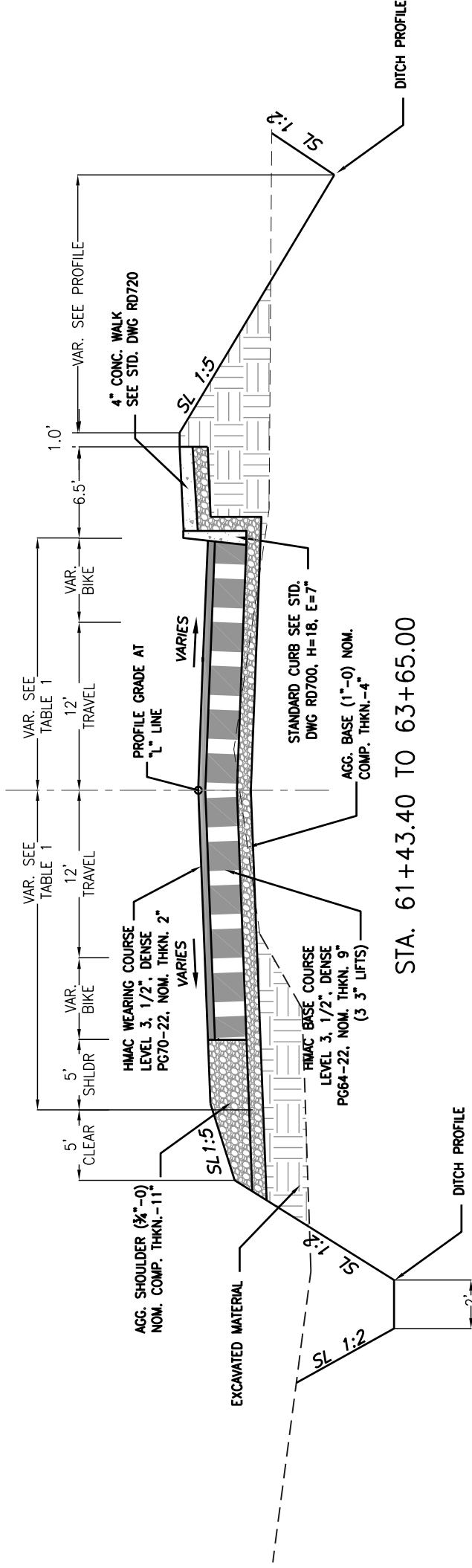

STA. 61+43.40 TO 63+65.00

"L" LINE

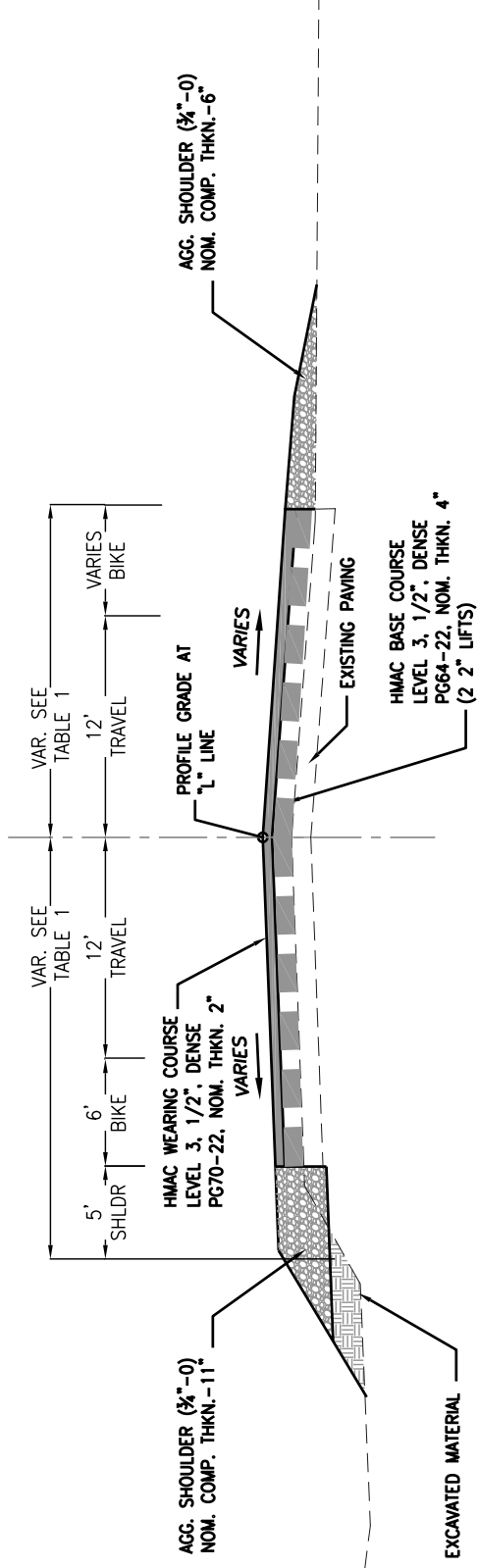

STA. 63+65.00 TO 64+50.00

TABLE 1

STATION	LEFT			RIGHT		
	TRAV.	BIKE	PKNG.	TRAV.	BIKE	PKNG.
57+50	12.0'	6.0'	8.0'	12.0'	6.0'	8.0'
58+27.77				12.0'	6.0'	8.0'
58+50.00				12.0'	6.0'	0.0'
60+25.00	12.0'	6.0'	8.0'	12.0'	6.0'	0.0'
60+48.29	12.0'	7.0'	1.9	12.0'	6.0'	0.0'
60+88.37	12.0'	7.0'	0.0	12.0'	7.0'	0.0'
61+60.39				12.0'	7.0'	0.0'
61+69.41	12.0'	7.0'	0.0	19.0'		
61+90.00	12.0'	6.0'	0.0	18.0'	6.0'	0.0
63+65	12.0'	6.0'	0.0	18.0'	6.0'	0.0
64+50	12.0'	6.0'	0.0	18.0'	0.0	0.0

SEE BRIDGE PLANS FOR TYPICAL SECTION ON STRUCTURE
STATIONS 60+63.4 TO 61+43.4

Marion County Dept. of Public Works
Engineering

MILL CREEK BR.1501
DENVER ST.-MARION RD.
BRIDGE REPLACEMENT

DATE: 12/22/08
DESIGNER: [Name]
CHECKED BY: [Name]
APPROVED BY: [Name]

SCALE: [Scale]
SHEET: 2



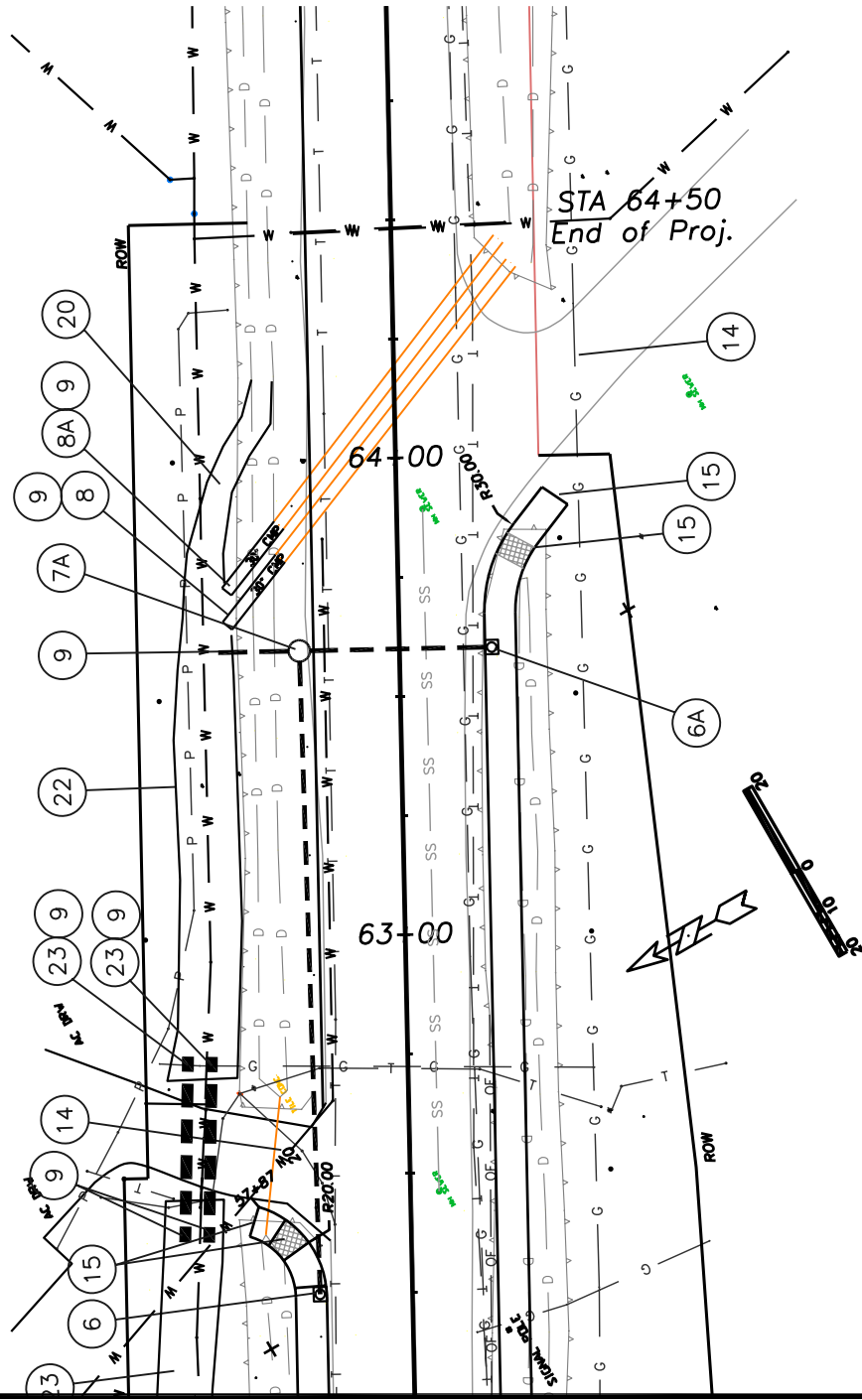
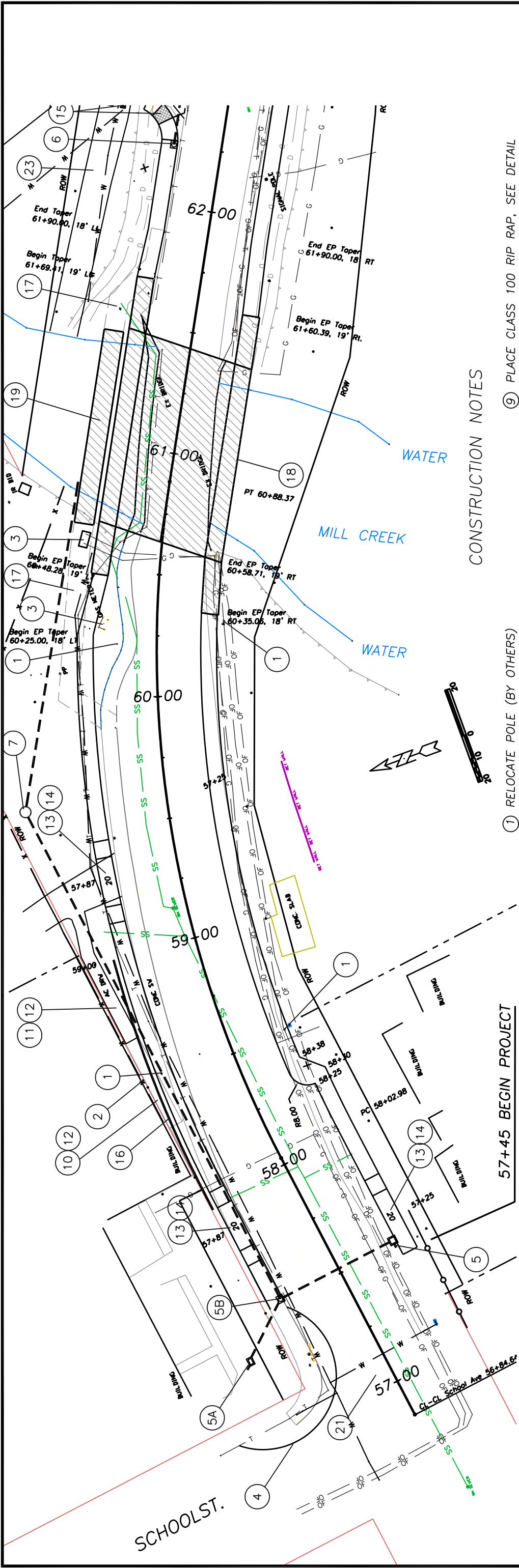

CONSTRUCTION NOTES

- ① RELOCATE POLE (BY OTHERS)
- ② RELOCATE ANCHOR (BY OTHERS)
- ③ RELOCATE GAS FACILITIES (BY OTHERS)
- ④ CONC. WALK BULB OUT (BY ENHANCEMENT PROJECT)
- ⑤ CONSTRUCT CONC. INLET, TYPE CG2 W/ TYPE 2 GRATE, SEE STD. DWG. RD366
- ⑥ INSTALL 12" STORM SEWER PIPE - 52
- ⑦ TRENCH EXCAVATION 14 CU. YD.
- ⑧A CONSTRUCT CONC. INLET, TYPE G1, SEE STD. DWG. RD 364
- ⑧B INSTALL 12" STORM SEWER PIPE - 29.3 W/ 3' STUB
- ⑨ TRENCH EXCAVATION 8 CU. YD.
- ⑩ CONSTRUCT CONC. INLET, TYPE CG3 W/ TYPE 2 GRATE, SEE STD. DWG. RD372
- ⑪ INSTALL 12" STORM SEWER PIPE - 210.2
- ⑫ TRENCH EXCAVATION 105 CU. YD.
- ⑬ CONSTRUCT CONC. INLET, TYPE CG3
- ⑭ INSTALL 12" STORM SEWER PIPE - 134.8
- ⑮ TRENCH EXCAVATION 52 CU. YD.
- ⑯A CONSTRUCT CONC. INLET, TYPE CG3
- ⑯B INSTALL 12" STORM SEWER PIPE - 40.4
- ⑰ TRENCH EXCAVATION 18 CU. YD.
- ⑱ INSTALL CONC. MANHOLE, WATER QUALITY
- ⑲A INSTALL 12" STORM SEWER PIPE - 136.7
- ⑲B TRENCH EXCAVATION 75 CU. YD.
- ⑲C INSTALL CONC. MANHOLE WITH WATER QUALITY INSERT,
- ⑲D INSTALL 12" STORM SEWER PIPE - 14
- ⑲E TRENCH EXCAVATION 5 CU. YD.
- ⑳ CONNECT TO EXISTING HDPE PIPE WITH WATERTIGHT GASKETED BAND PER MANUFACTURERS INSTRUCTIONS.
- ㉑ INSTALL 30" STORM SEWER PIPE - 16
- ㉒ TRENCH EXCAVATION 50 CU. YD.

- ⑨ PLACE CLASS 100 RIP RAP, SEE DETAIL ON SHT. 2A2 - 8 CU. YD.
- ⑩ REMOVE CONC. WALK AND BASE - 9 SQ. YD.
- ⑪ REMOVE ASPH CONC. WALK AND BASE - 12
- ⑫ PLACE TOP SOIL, SEE DETAIL ON SHT. 2A3 - 30 CU. YD.
- ⑬ CONSTRUCT CONC. DRIVEWAY, SEE STD. DWG. RD750
- ⑭ CONSTRUCT ASPHALT APPROACH - 5 EA.
- ⑮ CONSTRUCT CONC. SIDEWALK RAMPS, SEE STD. DWGS. RD755 AND RD760 - 4 EA.
- ⑯ CONSTRUCT SEGMENTAL RETAINING WALL, SEE DETAILS ON SHT. 2A3 - 250 SQ. FT.
- ⑰ PLACE FILL AND AGG. BASE FOR TEMP WALK, SEE DETAIL ON SHT. 2A2
- ⑱ REMOVE EXISTING BRIDGE AND CONSTRUCT CONC. BRIDG, SEE SHEETS 5-9
- ⑲ CONSTRUCT TEMP BRIDGE FOR PED PATH, SEE SHT 10
- ⑳ CONNECT DITCH, MATCH EXISTING SECTION
- ㉑ CONSTRUCT ROAD CONNECTION, SEE DETAIL ON SHT. 2A2
- ㉒ CONSTRUCT DITCH AT TOE OF SLOPE
- ㉓ INSTALL 30" STORM SEWER PIPE - 77.6
- TRENCH EXCAV. = 65 CU. YD.

Marion County Dept. of Public Works Engineering

 Tel: (503) 325-3000

MILL CREEK BR 1501

DENVER ST - MARION RD

BRIDGE REPLACEMENT

 Date: 12/18/05

 Revised: 01/04/06

 Drawn: J

 Checked: J

 SCALES

 Horiz: 1"=40'

 Vert: N/A

PROFILE

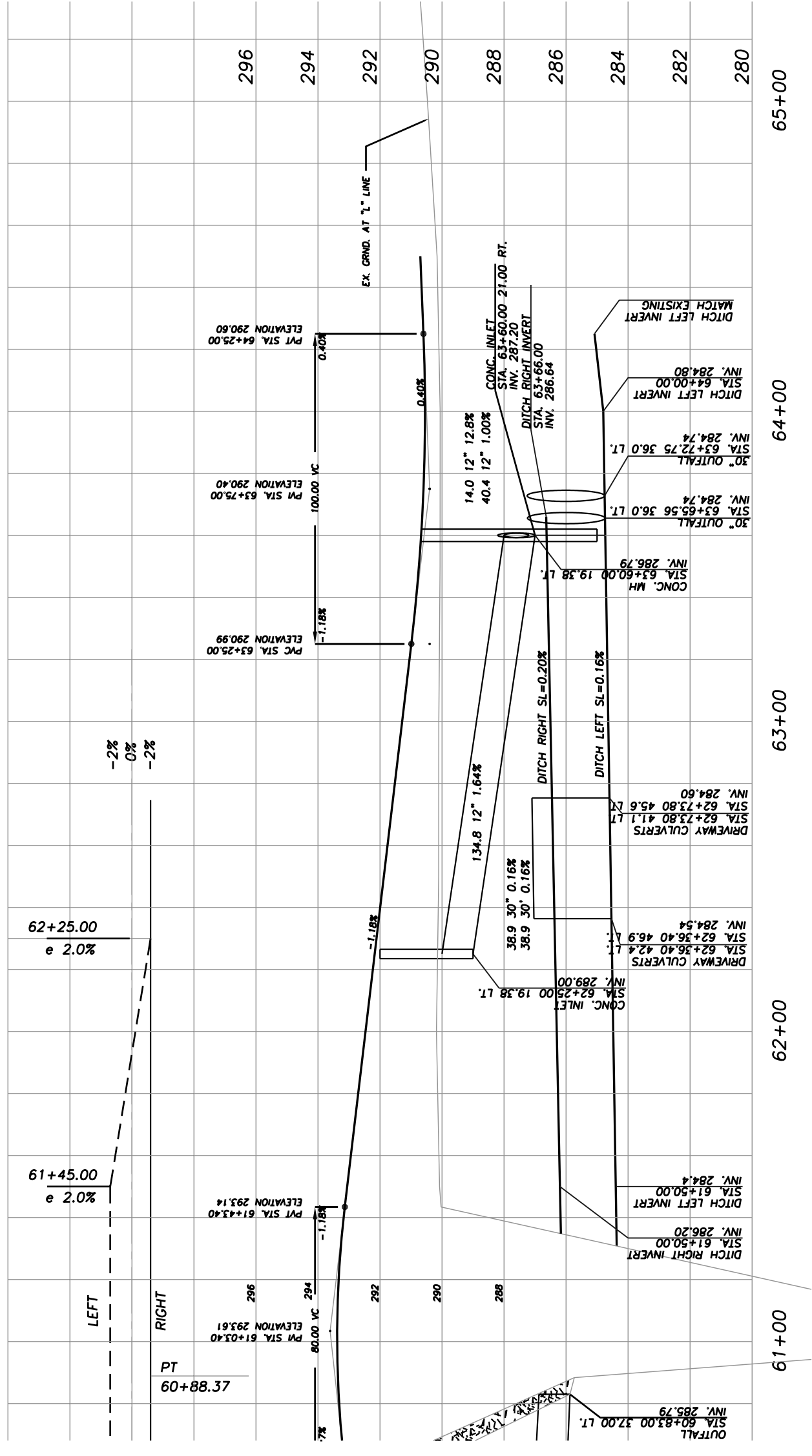

Marion County Dept. of Public Works
 Engineering
 138
 Salem, Oregon
MILL CREEK BR 1501
DENVER ST - MARION RD.
BRIDGE REPLACEMENT

Date: DC	Eng:	Checked By: Survey	Project:
Date: 12/18/08	Quinn, MZ	Quinn, MZ	Mar: 1'-0"
Revised: 01/02/08	SCALES		Vert: N/A